

A.M.R.E. CARPI MODENA ITALY

FICHE TECNICA

MOTORE TRAZIONE	TENSIONE	POTENZA	CORRENTE	TEMPI DI SERVIZIO	VELOCITA'	PESO	CLASSE D'ISOLAMENTO
CODICE AMRE 16513Y	80 VOLT	30 KW	446 AMP	S2 60 MIN S3 60 %	1380 G/M	300 Kg	H

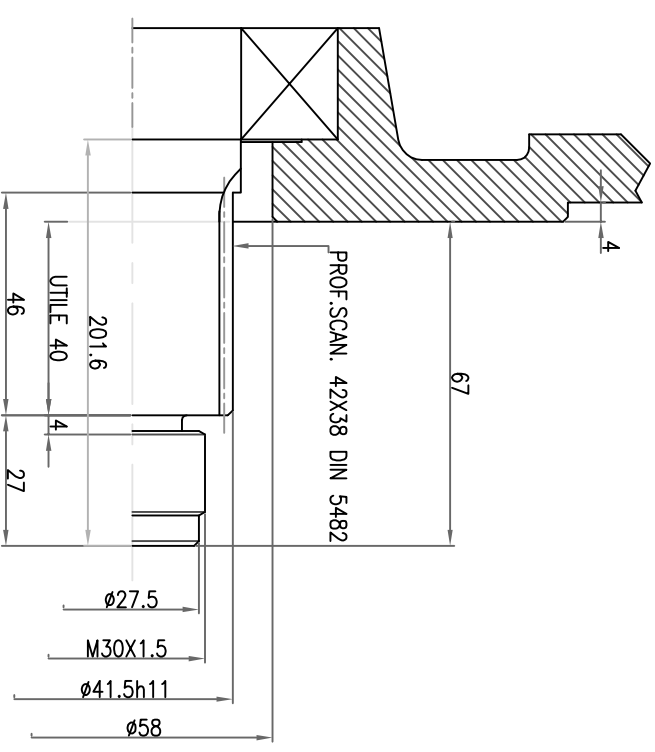
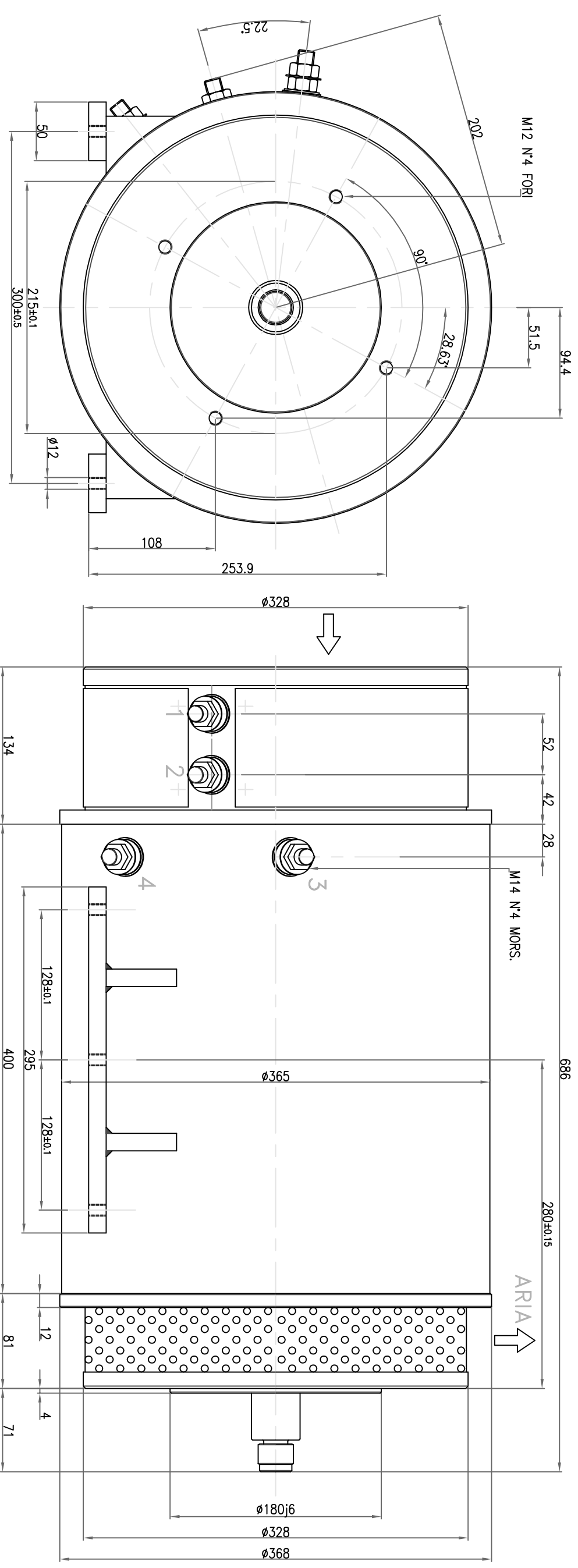

MOTORE CONFORME
ALLE NORMATIVE
I.E.C. C.E.I. C.E.F.



SCHEMA ELETTRICO

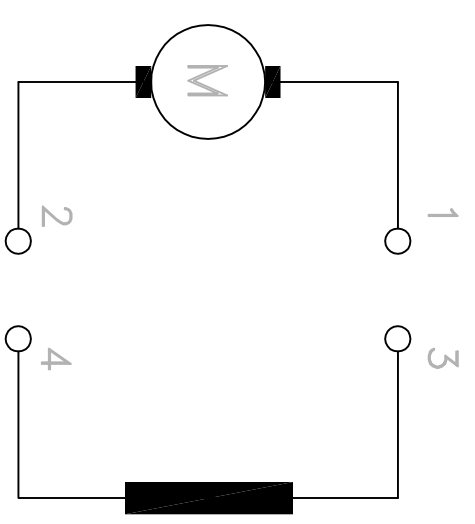

FILE

16513Y

DISEGNATORE

DATA

RESP.