

A.M.R.E.  
CARPI  
MODENA  
ITALY

FICHE TECNICA

MOTORE TRAZIONE CODICE	TENSIONE	POTENZA	CORRENTE	TEMPO DI SERVIZIO	VELOCITA'	PESO	CLASSE D'ISOLAMENTO
14066	80 VOLT	5 KW	78 AMP	S2 60 MIN	S3 60 %	1100 G/M	48 Kg
							H

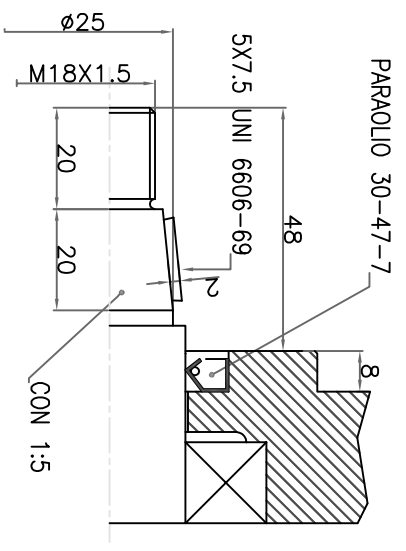
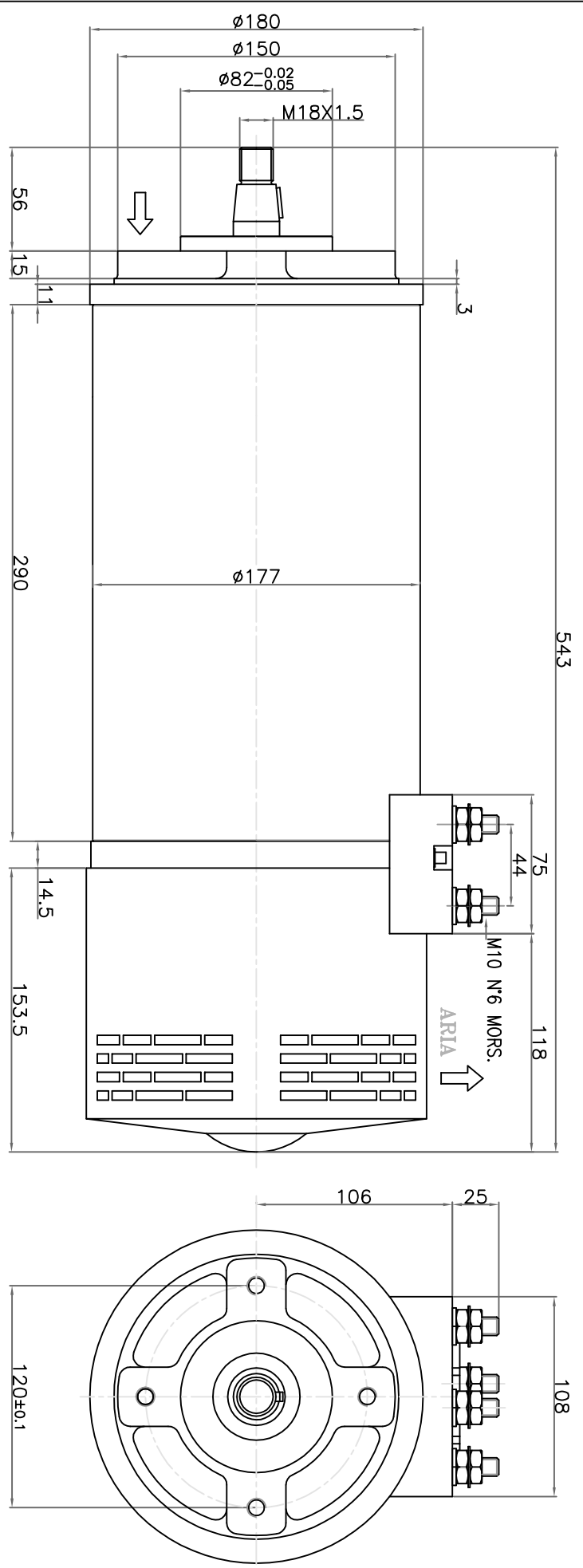

SCHEMA ELETRICO

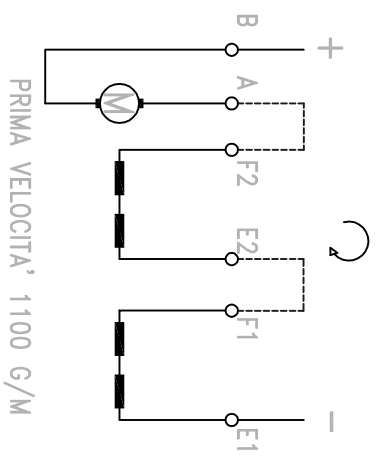

SCHEMA ELETRICO

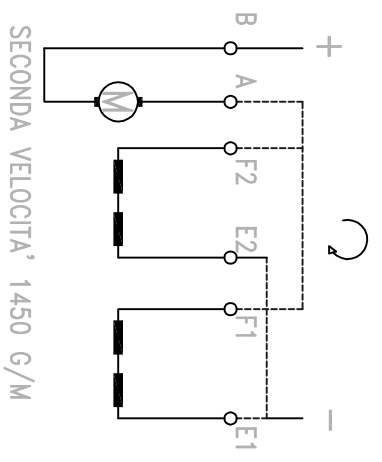

FILE 14066

DISEGNATORE

DATA

RESP.