

MOTORE TRAZIONE CODICE	TENSIONE VOLT	POTENZA KW	CORRENTE AMP	TEMPO DI SERVIZIO S2 MIN	VELOCITA' G/M	PESO Kg	CLASSE D'ISOLAMENTO
1 4056	48	5	1 30	60	2500	35	H
				S3 %			
				90			

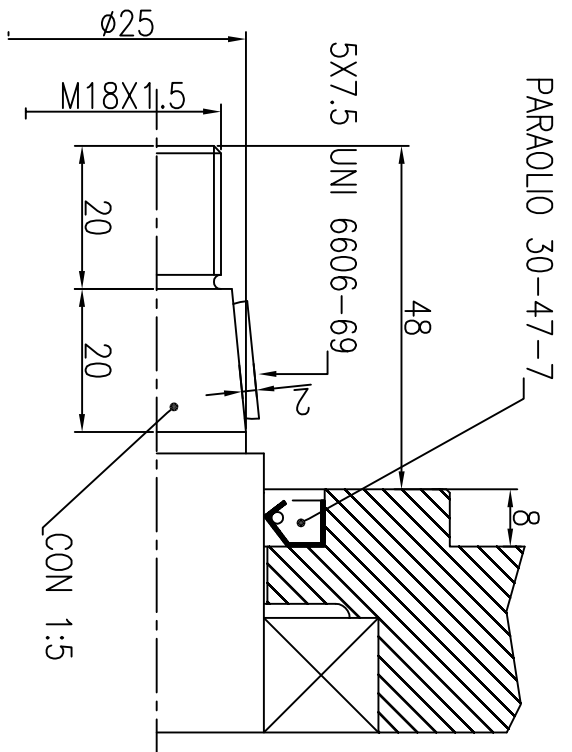

**SCHEMA ELETTRICO**

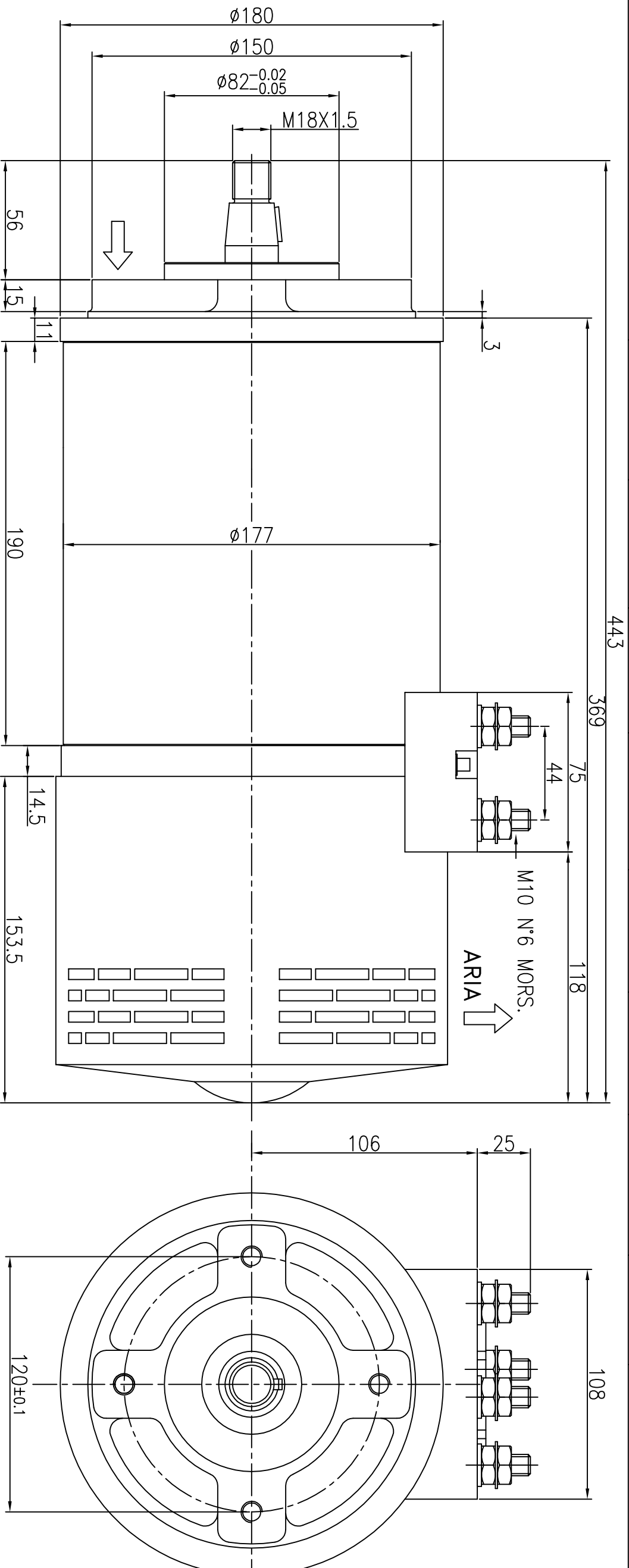
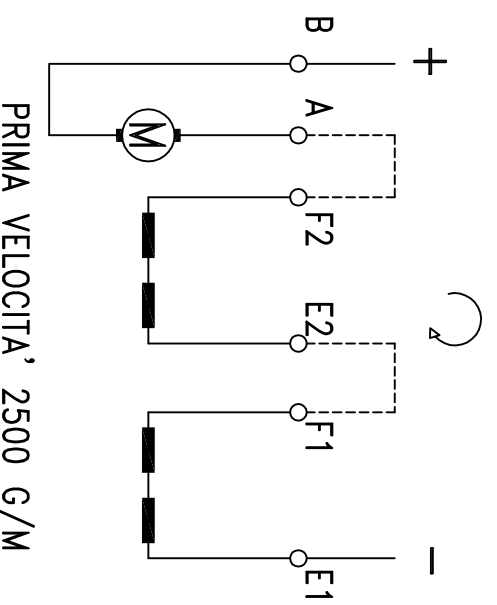

**SCHEMA ELETTRICO**

